

# ORRC Blue Lakes Half Marathon - Portland OR

## USATF Certification # OR18025LB

### Certification effective 10/9/2018 to 12/31/2028

Course is exact out and back

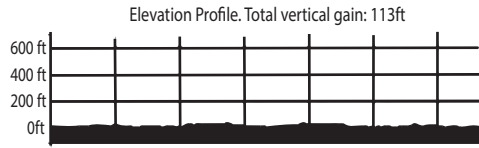

Lowest Point: 20ft Highest Point: 52ft

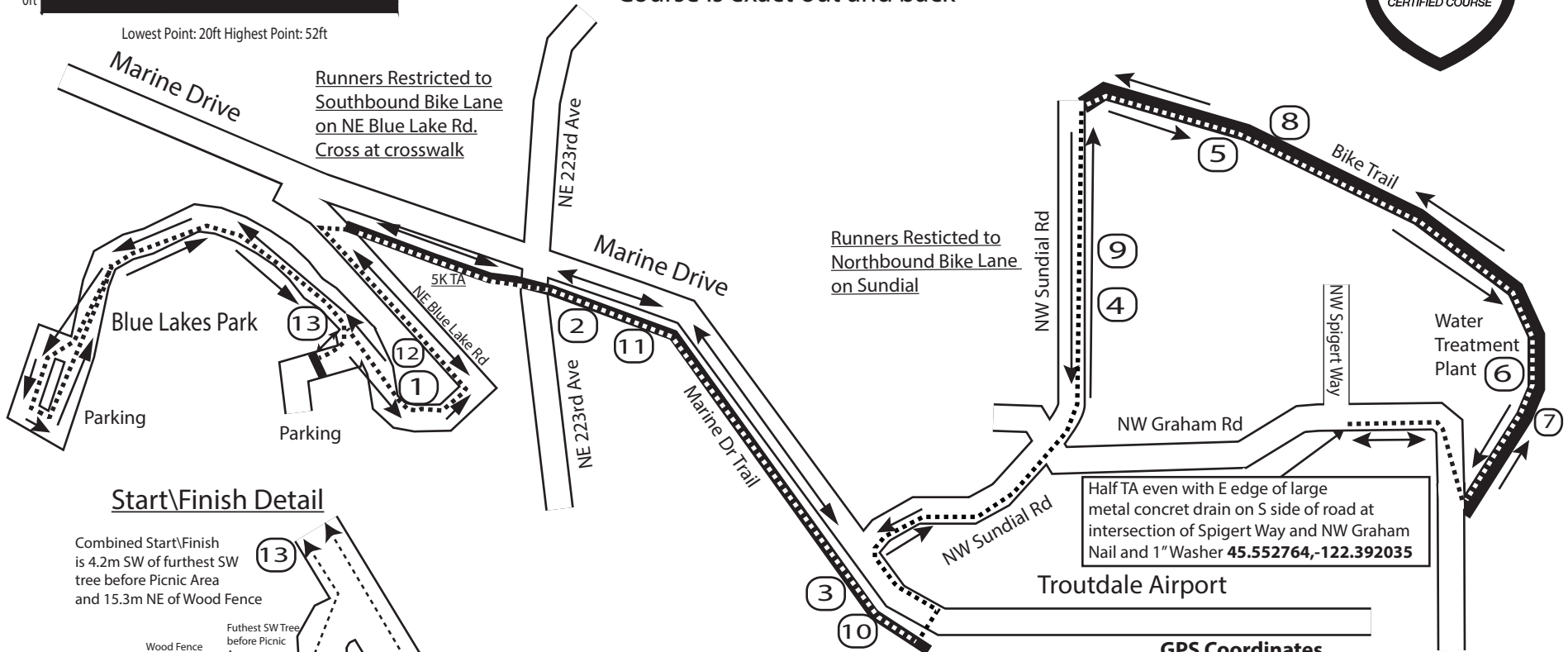

### Start/Finish Detail

Combined Start/Finish is 4.2m SW of furthest SW tree before Picnic Area and 15.3m NE of Wood Fence

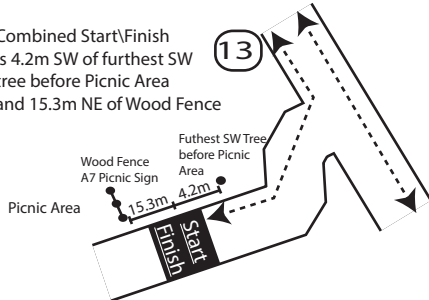

Runners come to intersection 4 times  
1st time they turn Left  
2nd and 3rd time they go straight  
4th time they turn Right to finish

Measured by Jeff Huber on 09/30/2018

[jeff@hubertiming.com](mailto:jeff@hubertiming.com)

Online map: <https://goo.gl/adLHEv>

*Jeff Huber*

### Splits

- Mile 1** - Even w blue "Pay to Park" sign on E side of road
- Mile 2** - 44.45m W of Mile 13 green sign
- Mile 3** - 40.95m W of Mile 14 green sign
- Mile 4** - 16.3m S of driveway to 1625 Sundial Rd
- Mile 5** - 19.7m E of 2" washer stamped "DEA Control"
- Mile 6** - 175.76m N of Mile 7. E of wastewater plant pool
- Mile 7** - 40m S of powerpole even w large water tank to W
- Mile 8** - 13.79m E of large Port of Portland Private Property sign
- Mile 9** - 23.85m N of speed limit sign
- Mile 10** - Even w W edge of green metal "Multilink" utility box
- Mile 11** - 42.19m E of stop line immediately after of crosswalk
- Mile 12** - Even w Pedestrians Ahead Sign on N side of road
- Mile 13** - 4.55m W of Bike and Pedestrians Sign at crosswalk

### GPS Coordinates

Use these only to get close to mile. Use description to set mile marks

- Start/Finish** - 45.55603, -122.44703
- Mile 1** - 45.55544421, -122.44547632
- Mile 2** - 45.55703673, -122.43433126
- Mile 3** - 45.54906399, -122.41787337
- Mile 4** - 45.55161461, -122.40970833
- Mile 5** - 45.56029097, -122.40103496
- Mile 6** - 45.55327927, -122.38527756
- Mile 7** - 45.55210456, -122.38672739
- Mile 8** - 45.55995766, -122.39879908
- Mile 9** - 45.55270337, -122.40810991
- Mile 10** - 45.54817572, -122.41602479
- Mile 11** - 45.55663601, -122.43223738
- Mile 12** - 45.55659896, -122.44624066
- Mile 13** - 45.55709051, -122.44722496