

ORRC Blue Lakes Half Marathon - Portland OR

USATF Certification # OR17022LB

Certification effective 10/13/2017 to 12/31/2027



Course is exact out and back

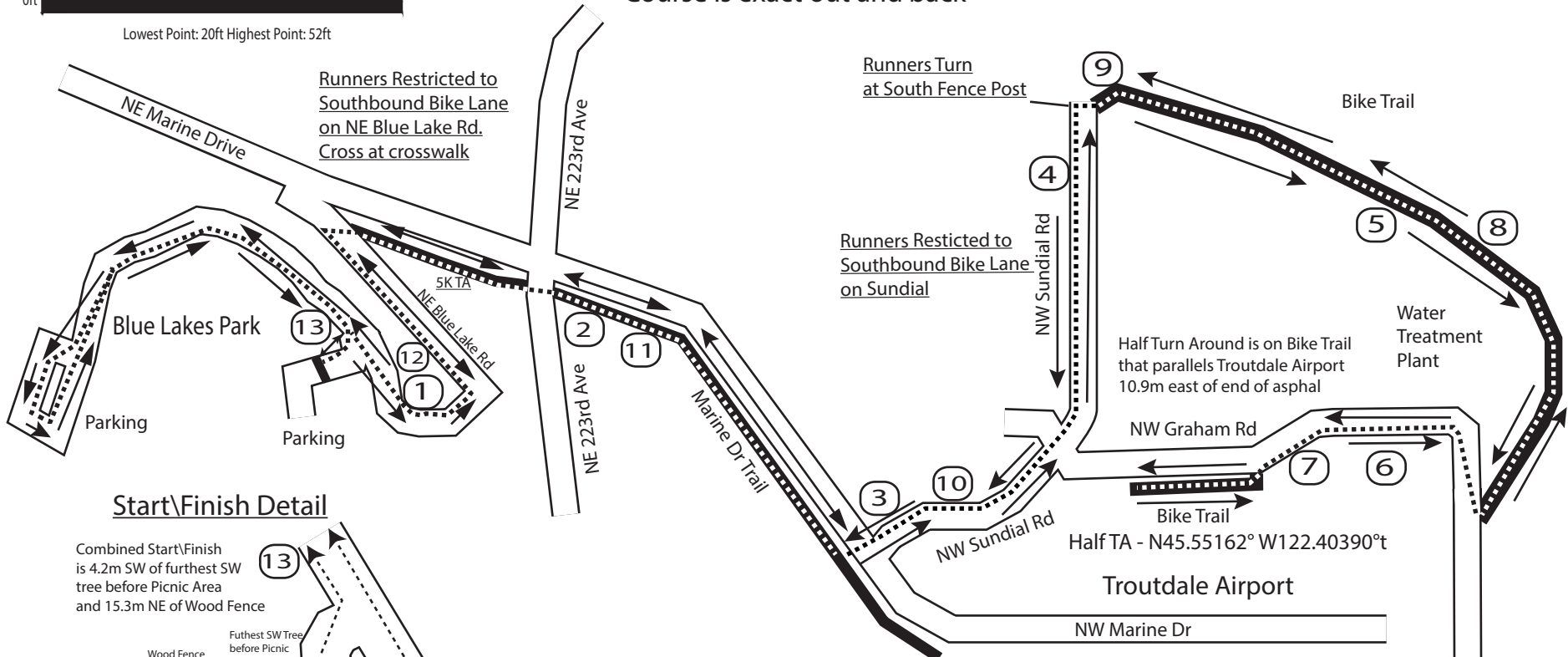
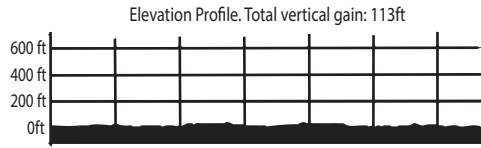

Start/Finish Detail

Combined Start/Finish is 4.2m SW of furthest SW tree before Picnic Area and 15.3m NE of Wood Fence

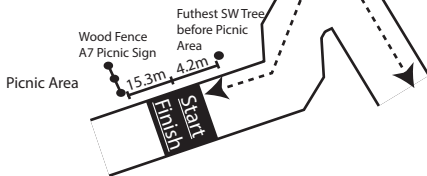

Runners come to intersection 4 times
1st time they turn Left
2nd and 3rd time they go straight
4th time they turn Right to finish

Splits (All written with blue paint in Oct. 2017)

- Mile 1** - 13.95m W of metal post park gate opens to
- Mile 2** - 35.35m W of Mile 13 green sign
- Mile 3** - 21.85m S of Light Signal in-ground box
- Mile 4** - Directly across from Sundial Access south of bike path
- Mile 5** - On 40 Mile Loop Bike Path. PK nail.
- Mile 6** - 23.25m west of Highway 84 Ahead Sign
- Mile 7** - 17.95m E of nearest light pole (see GPS Coordinates)
- Mile 8** - On 40 Mile Loop Bike Path. 163m E of mile 5
- Mile 9** - 40.47m E of Yellow Posts marking beginning of trail
- Mile 10** - 20.55m NE of 84 Right Sign
- Mile 11** - 75m E of path cross onramp from Gresham
- Mile 12** - 4.35m N of Pedestrians Ahead Sign
- Mile 13** - At crosswalk at Bike and Pedestrians Sign

GPS Coordinates

- Mile 1** - N45.55547° W122.44543°
- Mile 2** - N45.55703° W122.43425°
- Mile 3** - N45.54985° W122.41769°
- Mile 4** - N45.55962° W122.40789°
- Mile 5** - N45.55751° W122.38958°
- Mile 6** - N45.55275° W122.39278°
- Mile 7** - N45.55275° W122.39500°
- Mile 8** - N45.55668° W122.38756°
- Mile 9** - N45.56092° W122.40715°
- Mile 10** - N45.55048° W122.41560°
- Mile 11** - N45.55657° W122.43208°
- Mile 12** - N45.55664° W122.44634°
- Mile 13** - N45.55703° W122.44727°